

NORTHROCK IND.

VIBRATOR MOTOR PARTS LIST:

NO.	DESCRIPTION	MODEL 1.5+	MODEL 2+	MODEL 3+
		PART No.	PART No.	PART No.
1	MOTOR HOUSING	105AD1	105AD1	105AG1
2	END BELL HOUSING	420B1	420B1	420D1
3	ARMATURE	475B1	475A1	475C1
4	FIELD	480B1	480A1	480C1
5	BALL BEARING	140C300	140C300	140C300
6	SPRING WASHER	380A1	380A1	380A1
7	BRUSH HOLDER	495A1	495A1	495A1
8	BRUSH	490A1	490A1	490A1
9	BRUSH CAP	500A1	500A1	500A1
10	OUTER PROTECTIVE BRUSH CAP	400C1	400C1	400C1
11	ELECTRIC SWITCH	425B1	425B1	425B1
12	WATER RESISTANT SWITCH SEAL	430A1	430A1	430A1
13	SWITCH MOUNTING PLATE	215J1	215J1	215J1
14	GROUNDING ELECTRIC CORD	505A1	505A1	505B1
15	WATER TIGHT STRAIN RELIEF	435A1	435A1	435B1
16	CAP FOR COMUTATOR SERVICE PORT	400B1	400B1	400B1
17	AIR FILTER	470A1	470A1	470B1
18	AIR FILTER COVER	215N1	215N1	215X1
19	END CAP	215M1	215M1	215M1
20	FRAME ASSEMBLY (2 EA)	440C1	440C1	440D1
21	CORE ADAPTER	LISTED BELOW	LISTED BELOW	LISTED BELOW
22	CASING ADAPTER	LISTED BELOW	LISTED BELOW	LISTED BELOW

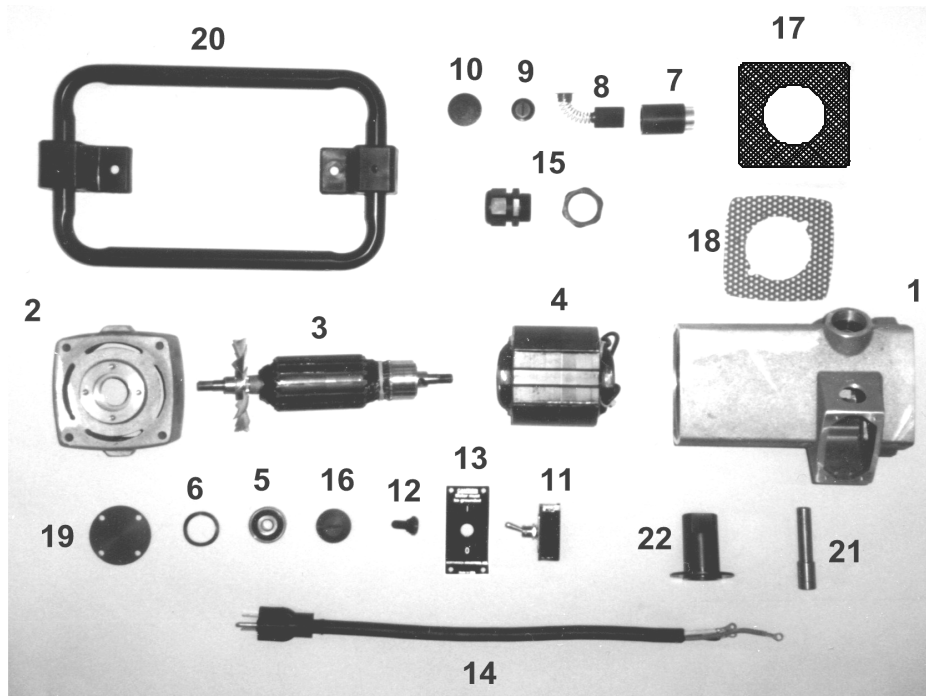

ORIG. MFG.	MODEL No.	CORE ADP. P/N:	CASING ADP. P/N:
DENVER	QM500, JM700	160BT1	150DJ1
DREYER	JE	160CX1	150FH1
DYNAPAC	AH15, AH25	160DK1	150FX1
MASTER	CV10, CV15, CV20	160AH2	150DB1
MIKASA	PMA-1, PMA-2, PMA-3	160DD1	150FR1
NORTHROCK	1.5+, 2+, 3+	160AH1	150DW1
NORTHROCK	1.5+, 2+, 3+ W/Q.D.	160CW1	150DE1
OZTEC	1.2, 1.8, 2.4, 3.2	160AH1	150CX1
OZTEC	1.2, 1.8, 2.4, 3.2 W/Q.D.	160CW1	150DE1
REMINGTON	VL	160CT2	150DF1
REMINGTON	1EV, 2EV, 3EV	160BM1	150DF1
STONE	1HP, 1 1/2HP, 2HP, 3HP	160AH3	150DC1
STOW	PENCIL	160BF1	150DD1
STOW	NO Q.D.	160BG1	150CY1
STOW	WITH Q.D.	160BD1	150DE1
VIBER	VME	160AH4	150CW1
WACKER	M1000, M2000, M3000	160BD2	150DE1
WYCO	990, 991, 991 1/2	160CT1	150DG1
WYCO	902, 992	160BP1	150DG1
WYCO	992 1/2	160CT1	150DH1
WYCO	903, 993	160BP1	150DH1

TEL: 1-800-989-8423

FAX: 1-800-315-1277